

# ORCHARDS OF WESTLAKE - PHASE I

BEING PORTIONS OF SECTIONS 5, 6, 7 AND 8, ALL IN  
TOWNSHIP 43 SOUTH, RANGE 41 EAST,  
CITY OF WESTLAKE, PALM BEACH COUNTY, FLORIDA.

## LEGEND

- |   |   |
|---|---|
| P.O.B. ----- POINT OF BEGINNING                 | N.T. ----- NON-TANGENT  |
| P.O.C. ----- POINT OF COMMENCEMENT              | N.T.C. ----- NON-TANGENT CURVATURE  |
| P.B. ----- PLAT BOOK                            | P.C. ----- POINT OF CURVATURE   |
| D.B. ----- DEED BOOK                            | P.T. ----- POINT OF TANGENCY  |
| O.R./O.R.B. ----- OFFICIAL RECORDS BOOK         | R/W ----- RIGHT-OF-WAY  |
| PG./PG(S) ----- PAGE(S)                         | (R) ----- RADIAL  |
| NAD ----- NORTH AMERICAN DATUM                  | (NR) ----- NON-RADIAL   |
| W.M.T. ----- WATER MANAGEMENT TRACT             | HOA ----- HOMEOWNERS ASSOCIATION  |
| O.S.T. ----- OPEN SPACE TRACT                   | S.I.D. ----- SEMINOLE IMPROVEMENT DISTRICT                                      |
| P.B.C. ----- PALM BEACH COUNTY                  | PRM ----- PERMANENT REFERENCE MONUMENT  |
| U.E. ----- UTILITY EASEMENT                     | ● ----- PERMANENT CONTROL POINT   |
| D.E. ----- DRAINAGE EASEMENT                    | □ ----- FOUND PERMANENT REFERENCE MONUMENT                                      |
| L.M.A.E. ----- LAKE MAINTENANCE ACCESS EASEMENT | ■ ----- SET 4"x4" CONCRETE MONUMENT WITH 2" ALUMINUM DISK STAMPED "PRM LB 7768" |
| 7-43-41 ----- SECTION-TOWNSHIP-RANGE            |   |
| R ----- RADIUS                                  |   |
| L ----- ARC LENGTH                              |   |
| D ----- DELTA ANGLE                             |   |
| CB ----- CHORD BEARING                          |   |
| C ----- CHORD                                   |   |

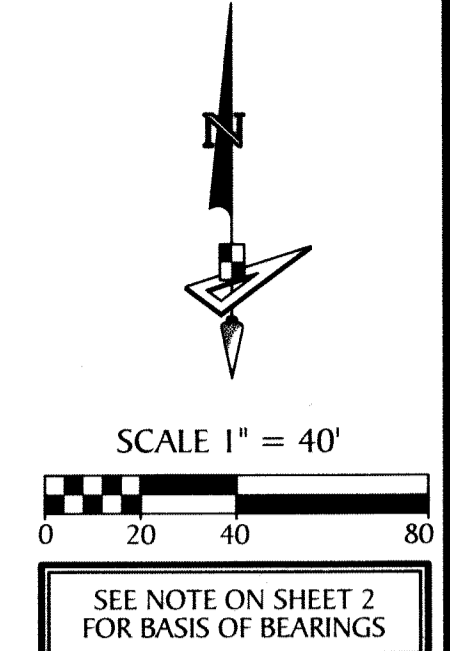
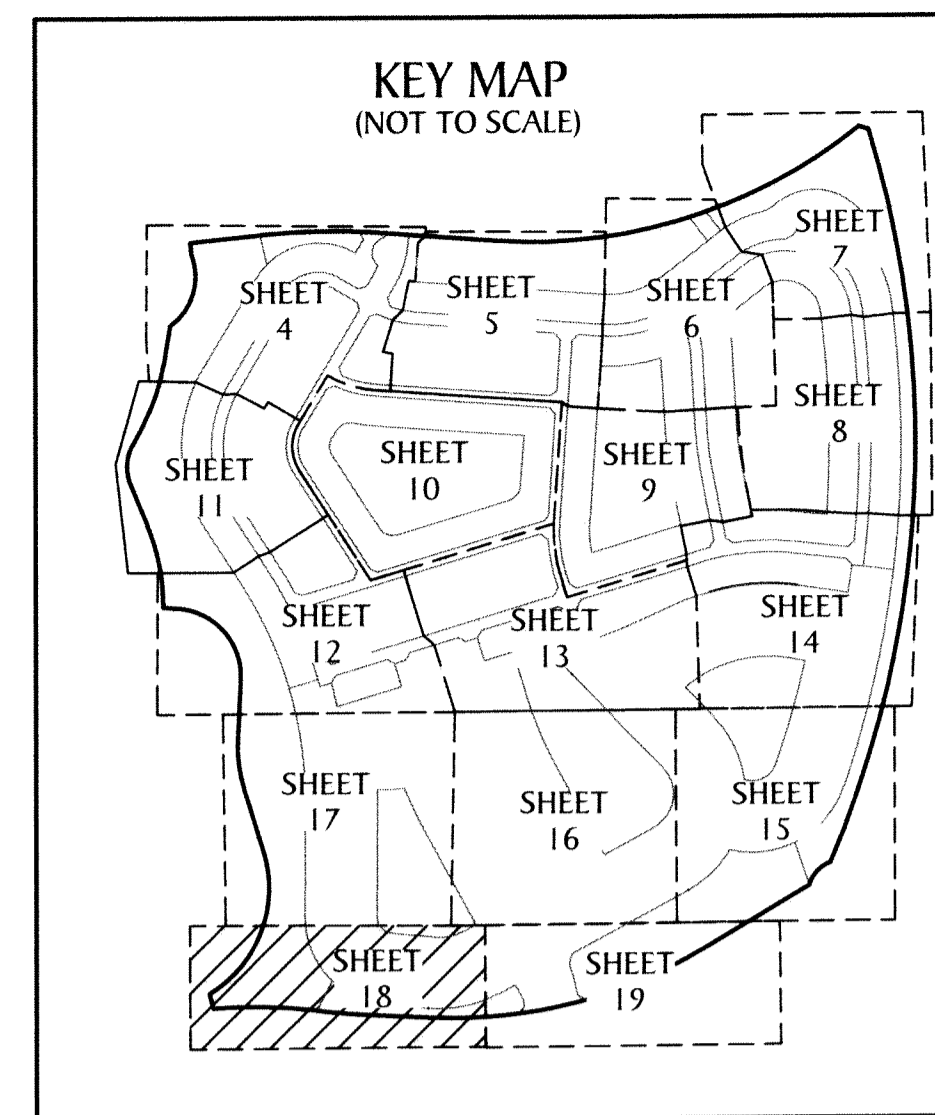

209

